

Fit fast, hold fast



SAVETIX®

captive screw technology

in compliance with
EU Directive
2006/42/EC

Technical specifications

Applications of Savetix® washers and Savetix® screws:

Product used	Application	Characteristics	Advantage
Savetix® washers and Savetix® screws as a set 	After fitting, the Savetix® washer is held by the thinner part of the screw shank, but is fully movable.	Since the screw has considerable freedom of movement, this version is recommended where a machine requires frequent maintenance.	<ul style="list-style-type: none"> • Maximum security. • Maximum convenience. • Fully complies with the EU Directive.
Self-adhesive Savetix® washers and Savetix® screws as a self-adhesive set 	As above, but with self-adhesive washers.	As above, but this set simplifies simultaneous fitting of many screws. Improves convenience and safety during installation.	<ul style="list-style-type: none"> • Maximum security. • Maximum convenience. • Maximum time-saving. • Fully complies with the EU Directive.

Savetix® Adhesive

Description:

This glue is a modified, solvent-free acrylate adhesive. It has excellent tack and instantly adheres well to most surfaces including such difficult surfaces as foam and PE or PP film. The glue is free of APEOs.

Technical specifications

Backing material:	Nonwoven fabric 12 g/m ²
Cover:	Release paper, yellow, 90 g/m ²
Glue application weight:	90 g/m ²
Total thickness:	0.10 mm
Adhesive strength:	min. 16 N / 25 mm ² (contact time: 1 hr)
Temperature resistance:	from -40°C to +100°C

Size charts

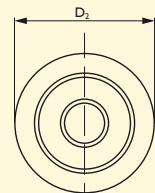
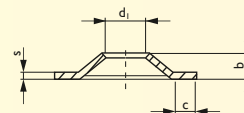

Size (nominal size)	Diameter of hole d ₁ min.	Outer diameter D ₂	Thickness s (nominal size)	Height b max.	Contact area c min.	Material
M4	4.1 mm	19.5 mm	0.6 mm	3.8 mm	2.7 mm	A2 - 1.4301
M5	5.1 mm	20.5 mm	1.0 mm	4.0 mm	2.7 mm	
M6	6.1 mm	21.5 mm	0.8 / 1.0 mm	4.2 mm	2.7 mm	
M8	8.1 mm	25.0 mm	1.0 / 1.5 mm	5.4 mm	2.7 mm	
M10	10.1 mm	27.5 mm	1.5 mm	5.8 mm	2.7 mm	
M12	12.1 mm	29.5 mm	1.8 mm	6.5 mm	2.7 mm	

Savetix® is also available in special, customer specific sizes.

Captive hex screw with a thin shaft, hex head in accordance with DIN 933

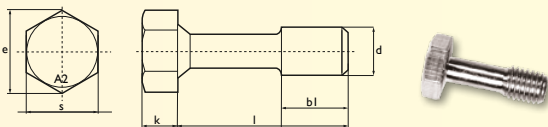

Size (nominal size) d	Spanner size s	Head height k	Length l	Threaded length bl	Material
M4	7 mm	2.8 mm	The following lengths are available: 6, 8, 10, 12, 14, 16, 20, 25, 30, 35, 40 and 45 mm (length depends on size)	To customer specification min. 4 mm	A2 - 1.4301
M5	8 mm	3.5 mm			
M6	10 mm	4.0 mm			
M8	13 mm	5.3 mm			
M10	17 mm	6.4 mm			
M12	19 mm	7.5 mm			

Captive cheese head screw with a thin shaft, head in accordance with DIN 912

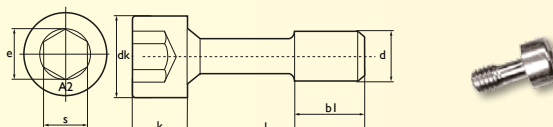

Size (nominal size) d	Spanner size s	dk	Head height k	Length l	Threaded length bl	Material
M4	3 mm	7 mm	4 mm	The following lengths are available: 6, 8, 10, 12, 14, 16, 20, 25, 30, 35, 40 and 45 mm (length depends on size)	To customer specification min. 4 mm	A2 - 1.4301
M5	4 mm	8.5 mm	5 mm			
M6	5 mm	10 mm	6 mm			
M8	6 mm	13 mm	8 mm			
M10	8 mm	16 mm	10 mm			
M12	10 mm	18 mm	12 mm			

Also available in other screw geometries.



Rudolf Rafflenbeul
Stahlwarenfabrik GmbH & Co.

Eilper Strasse 126-128 · 58091 Hagen, Germany · www.rafflenbeul.de · www.savetix.de · verkauf@rafflenbeul.de